

Your Piece of

Gujarat

*Godrej* | PROPERTIES

INDIA'S NO. 1\*  
REAL ESTATE  
DEVELOPER



\*As per booking value achieved in FY 2023-24 and FY 2024-25 for residential real estate.



# The Godrej Story



Godrej Properties carries forward the 128-year-old legacy of the Godrej Group, bringing its core values of innovation, sustainability, and excellence to the real estate industry. With an unwavering commitment to cutting-edge design and technology, Godrej Properties consistently strives to create homes that stand on a foundation of excellence, trust and impeccable quality while fostering lasting relationships with our customers. We endeavour to make every project that we deliver perfectly suited for your family.







## Our portfolio at a glance

### Delhi-NCR

48 mn sq.ft. / 31 PROJECTS

### Kolkata

9.2 mn sq.ft. / 5 PROJECTS

### Ahmedabad

24.3 mn sq.ft. / 2 PROJECTS

### Hyderabad

5.2 mn sq.ft. / 2 PROJECTS

### Indore

1.97 mn sq.ft. / 2 PROJECTS

### Bengaluru

34.3 mn sq.ft. / 18 PROJECTS

### Mumbai

52.7 mn sq.ft. / 31 PROJECTS

### Kochi

2.2 mn sq.ft. / 1 PROJECT

### Pune

53.9 mn sq.ft. / 17 PROJECTS

### Chennai

5.0 mn sq.ft. / 3 PROJECTS

### Nagpur

4.0 mn sq.ft. / 2 PROJECTS

### Chandigarh

0.5 mn sq.ft. / 1 PROJECT

12+

CITIES

34

YEARS OF  
EXPERIENCE

240+

MN SQ.FT. TOTAL  
SALEABLE AREA

400+

AWARDS &  
RECOGNITIONS

85,000+

HAPPY FAMILIES



## A legacy of successful plotted developments across the country

**VERDANIA ESTATE**

## GODREJ GREENVIEW ESTATE

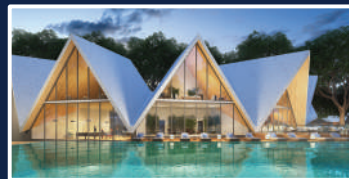

**GODREJ COUNTRY ESTATE**

**GODREJ HILLVIEW ESTATE****GODREJ GOLF SIDE ESTATE**

**GODREJ GREEN ESTATE**



**GODREJ PARKLAND ESTATE**



## GODREJ RETREAT



**GODREJ ORCHARD ESTATE**



**GODREJ FOREST ESTATE**



**GODREJ ZEN ESTATE**



**GODREJ WOODPARK**

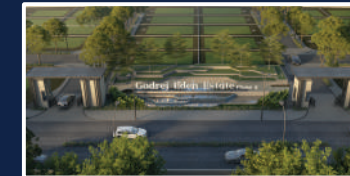

**GODREJ EDEN ESTATE PHASE 1 & 2**



**GODREJ EDEN ESTATE PHASE 3**



**GODREJ WOODLAND**



**GODREJ RESERVE**



**GODREJ SUNRISE ESTATE**



The projects are registered as Godrej Golf Side Estate\*, 'Godrej Hillview Estate' and 'Godrej Country Estate' under Godrej bearing No. PSJ20000549V4 and PSJ20000553A8 and PP90000482A5 respectively, all available at <http://maharera.mahonline.gov.in/>. Godrej Green Estate: The project is registered as Godrej Green Estate Haryana Real Estate Regulatory Authority vide RERA Registration No. HRERA-PKL-SNP-348-2022 (website: <https://haryanaera.mahaonline.gov.in/>), [Godrej Retreat: The project is registered as Godrej Retreat HRERA-PKL-FBD-210-2020, <https://haryanaera.mahaonline.gov.in/>] Godrej Park Land: The project is registered as Godrej Park Land HRERA-PKL-KRK-4483-2023, <https://haryanaera.mahaonline.gov.in/>] Godrej Orchard: The project is registered as Godrej Orchard Estate bearing RERA Registration No. PSJ20000484A6 available at <http://maharera.mahaonline.gov.in/> [The project registered as Godrej Forest Estate bearing RERA Registration No. PSJ20000540V3 available at <http://maharera.mahaonline.gov.in/>] Godrej Reserve: The project is registered as Godrej Reserve Phase 1 bearing RERA Registration No. PSJ20000522V4 available at <http://www.keralaera.mahaonline.gov.in/> [The project registered as Godrej Woodland Park V4 bearing RERA Registration No. PSJ20000522V4 available at <http://www.keralaera.mahaonline.gov.in/>] Godrej Wood Park: The project is registered as Godrej Wood Park bearing RERA Registration No. PSJ20000543Z6 and PSJ20000540V3 respectively, available at <http://maharera.mahaonline.gov.in/>. The project is registered as Godrej Sunrise RERA Registration No. TN/01/Layout/3492/2023, available at <https://rera.tn.gov.in>. Verdania Estate: The project is registered with Maharashtra Pradesh Real Estate Regulatory Authority (MPRERA) bearing Registration No. P-SWR-25-5891 available on MPRERA website (<https://www.mpra.mahaonline.gov.in/>). Godrej Eden Estate Phase 3 is registered with Maharashtra bearing registration no. PPT62002505U6. Available at <http://maharera.mahaonline.gov.in>. Godrej ZEN Estate: The project is registered with Maharashtra Pradesh Real Estate Regulatory Authority (MPRERA) bearing Registration No. P-SWR-25-5891 available on MPRERA website (<https://www.mpra.mahaonline.gov.in/>). Godrej ZEN ESTATE PHASE 1A, GODREJ ZEN ESTATE PHASE 1B, GODREJ ZEN ESTATE PHASE 1C, GODREJ ZEN ESTATE PHASE 1D, GODREJ ZEN ESTATE PHASE 1E, GODREJ ZEN ESTATE PHASE 1F, GODREJ ZEN ESTATE PHASE 1G, GODREJ ZEN ESTATE PHASE 1H, GODREJ ZEN ESTATE PHASE 1I, GODREJ ZEN ESTATE PHASE 1J, GODREJ ZEN ESTATE PHASE 1K, GODREJ ZEN ESTATE PHASE 1L, GODREJ ZEN ESTATE PHASE 1M, GODREJ ZEN ESTATE PHASE 1N, GODREJ ZEN ESTATE PHASE 1O, GODREJ ZEN ESTATE PHASE 1P, GODREJ ZEN ESTATE PHASE 1Q, GODREJ ZEN ESTATE PHASE 1R, GODREJ ZEN ESTATE PHASE 1S, GODREJ ZEN ESTATE PHASE 1T, GODREJ ZEN ESTATE PHASE 1U, GODREJ ZEN ESTATE PHASE 1V, GODREJ ZEN ESTATE PHASE 1W, GODREJ ZEN ESTATE PHASE 1X, GODREJ ZEN ESTATE PHASE 1Y, GODREJ ZEN ESTATE PHASE 1Z, GODREJ ZEN ESTATE PHASE 1AA, GODREJ ZEN ESTATE PHASE 1AB, GODREJ ZEN ESTATE PHASE 1AC, GODREJ ZEN ESTATE PHASE 1AD, GODREJ ZEN ESTATE PHASE 1AE, GODREJ ZEN ESTATE PHASE 1AF, GODREJ ZEN ESTATE PHASE 1AG, GODREJ ZEN ESTATE PHASE 1AH, GODREJ ZEN ESTATE PHASE 1AI, GODREJ ZEN ESTATE PHASE 1AJ, GODREJ ZEN ESTATE PHASE 1AK, GODREJ ZEN ESTATE PHASE 1AL, GODREJ ZEN ESTATE PHASE 1AM, GODREJ ZEN ESTATE PHASE 1AN, GODREJ ZEN ESTATE PHASE 1AO, GODREJ ZEN ESTATE PHASE 1AP, GODREJ ZEN ESTATE PHASE 1AQ, GODREJ ZEN ESTATE PHASE 1AR, GODREJ ZEN ESTATE PHASE 1AS, GODREJ ZEN ESTATE PHASE 1AT, GODREJ ZEN ESTATE PHASE 1AU, GODREJ ZEN ESTATE PHASE 1AV, GODREJ ZEN ESTATE PHASE 1AW, GODREJ ZEN ESTATE PHASE 1AX, GODREJ ZEN ESTATE PHASE 1AY, GODREJ ZEN ESTATE PHASE 1AZ, GODREJ ZEN ESTATE PHASE 1BA, GODREJ ZEN ESTATE PHASE 1BB, GODREJ ZEN ESTATE PHASE 1BC, GODREJ ZEN ESTATE PHASE 1BD, GODREJ ZEN ESTATE PHASE 1BE, GODREJ ZEN ESTATE PHASE 1BF, GODREJ ZEN ESTATE PHASE 1BG, GODREJ ZEN ESTATE PHASE 1BH, GODREJ ZEN ESTATE PHASE 1BI, GODREJ ZEN ESTATE PHASE 1BJ, GODREJ ZEN ESTATE PHASE 1BK, GODREJ ZEN ESTATE PHASE 1BL, GODREJ ZEN ESTATE PHASE 1BM, GODREJ ZEN ESTATE PHASE 1BN, GODREJ ZEN ESTATE PHASE 1BO, GODREJ ZEN ESTATE PHASE 1BP, GODREJ ZEN ESTATE PHASE 1BQ, GODREJ ZEN ESTATE PHASE 1BR, GODREJ ZEN ESTATE PHASE 1BS, GODREJ ZEN ESTATE PHASE 1BT, GODREJ ZEN ESTATE PHASE 1BU, GODREJ ZEN ESTATE PHASE 1BV, GODREJ ZEN ESTATE PHASE 1BW, GODREJ ZEN ESTATE PHASE 1BX, GODREJ ZEN ESTATE PHASE 1BY, GODREJ ZEN ESTATE PHASE 1BZ, GODREJ ZEN ESTATE PHASE 1CA, GODREJ ZEN ESTATE PHASE 1CB, GODREJ ZEN ESTATE PHASE 1CC, GODREJ ZEN ESTATE PHASE 1CD, GODREJ ZEN ESTATE PHASE 1CE, GODREJ ZEN ESTATE PHASE 1CF, GODREJ ZEN ESTATE PHASE 1CG, GODREJ ZEN ESTATE PHASE 1CH, GODREJ ZEN ESTATE PHASE 1CI, GODREJ ZEN ESTATE PHASE 1CJ, GODREJ ZEN ESTATE PHASE 1CK, GODREJ ZEN ESTATE PHASE 1CL, GODREJ ZEN ESTATE PHASE 1CM, GODREJ ZEN ESTATE PHASE 1CN, GODREJ ZEN ESTATE PHASE 1CO, GODREJ ZEN ESTATE PHASE 1CP, GODREJ ZEN ESTATE PHASE 1CQ, GODREJ ZEN ESTATE PHASE 1CR, GODREJ ZEN ESTATE PHASE 1CS, GODREJ ZEN ESTATE PHASE 1CT, GODREJ ZEN ESTATE PHASE 1CU, GODREJ ZEN ESTATE PHASE 1CV, GODREJ ZEN ESTATE PHASE 1CW, GODREJ ZEN ESTATE PHASE 1CX, GODREJ ZEN ESTATE PHASE 1CY, GODREJ ZEN ESTATE PHASE 1CZ, GODREJ ZEN ESTATE PHASE 1DA, GODREJ ZEN ESTATE PHASE 1DB, GODREJ ZEN ESTATE PHASE 1DC, GODREJ ZEN ESTATE PHASE 1DD, GODREJ ZEN ESTATE PHASE 1DE, GODREJ ZEN ESTATE PHASE 1DF, GODREJ ZEN ESTATE PHASE 1DG, GODREJ ZEN ESTATE PHASE 1DH, GODREJ ZEN ESTATE PHASE 1DI, GODREJ ZEN ESTATE PHASE 1DJ, GODREJ ZEN ESTATE PHASE 1DK, GODREJ ZEN ESTATE PHASE 1DL, GODREJ ZEN ESTATE PHASE 1DM, GODREJ ZEN ESTATE PHASE 1DN, GODREJ ZEN ESTATE PHASE 1DO, GODREJ ZEN ESTATE PHASE 1DP, GODREJ ZEN ESTATE PHASE 1DQ, GODREJ ZEN ESTATE PHASE 1DR, GODREJ ZEN ESTATE PHASE 1DS, GODREJ ZEN ESTATE PHASE 1DT, GODREJ ZEN ESTATE PHASE 1DU, GODREJ ZEN ESTATE PHASE 1DV, GODREJ ZEN ESTATE PHASE 1DW, GODREJ ZEN ESTATE PHASE 1DX, GODREJ ZEN ESTATE PHASE 1DY, GODREJ ZEN ESTATE PHASE 1DZ, GODREJ ZEN ESTATE PHASE 1EA, GODREJ ZEN ESTATE PHASE 1EB, GODREJ ZEN ESTATE PHASE 1EC, GODREJ ZEN ESTATE PHASE 1ED, GODREJ ZEN ESTATE PHASE 1EE, GODREJ ZEN ESTATE PHASE 1EF, GODREJ ZEN ESTATE PHASE 1EG, GODREJ ZEN ESTATE PHASE 1EH, GODREJ ZEN ESTATE PHASE 1EI, GODREJ ZEN ESTATE PHASE 1EJ, GODREJ ZEN ESTATE PHASE 1EK, GODREJ ZEN ESTATE PHASE 1EL, GODREJ ZEN ESTATE PHASE 1EM, GODREJ ZEN ESTATE PHASE 1EN, GODREJ ZEN ESTATE PHASE 1EO, GODREJ ZEN ESTATE PHASE 1EP, GODREJ ZEN ESTATE PHASE 1EQ, GODREJ ZEN ESTATE PHASE 1ER, GODREJ ZEN ESTATE PHASE 1ES, GODREJ ZEN ESTATE PHASE 1ET, GODREJ ZEN ESTATE PHASE 1EU, GODREJ ZEN ESTATE PHASE 1EV, GODREJ ZEN ESTATE PHASE 1EW, GODREJ ZEN ESTATE PHASE 1EX, GODREJ ZEN ESTATE PHASE 1EY, GODREJ ZEN ESTATE PHASE 1EZ, GODREJ ZEN ESTATE PHASE 1FA, GODREJ ZEN ESTATE PHASE 1FB, GODREJ ZEN ESTATE PHASE 1FC, GODREJ ZEN ESTATE PHASE 1FD, GODREJ ZEN ESTATE PHASE 1FE, GODREJ ZEN ESTATE PHASE 1FF, GODREJ ZEN ESTATE PHASE 1FG, GODREJ ZEN ESTATE PHASE 1FH, GODREJ ZEN ESTATE PHASE 1FI, GODREJ ZEN ESTATE PHASE 1FJ, GODREJ ZEN ESTATE PHASE 1FK, GODREJ ZEN ESTATE PHASE 1FL, GODREJ ZEN ESTATE PHASE 1FM, GODREJ ZEN ESTATE PHASE 1FN, GODREJ ZEN ESTATE PHASE 1FO, GODREJ ZEN ESTATE PHASE 1FP, GODREJ ZEN ESTATE PHASE 1FQ, GODREJ ZEN ESTATE PHASE 1FR, GODREJ ZEN ESTATE PHASE 1FS, GODREJ ZEN ESTATE PHASE 1FT, GODREJ ZEN ESTATE PHASE 1FU, GODREJ ZEN ESTATE PHASE 1FV, GODREJ ZEN ESTATE PHASE 1FW, GODREJ ZEN ESTATE PHASE 1FX, GODREJ ZEN ESTATE PHASE 1FY, GODREJ ZEN ESTATE PHASE 1FZ, GODREJ ZEN ESTATE PHASE 1GA, GODREJ ZEN ESTATE PHASE 1GB, GODREJ ZEN ESTATE PHASE 1GC, GODREJ ZEN ESTATE PHASE 1GD, GODREJ ZEN ESTATE PHASE 1GE, GODREJ ZEN ESTATE PHASE 1GF, GODREJ ZEN ESTATE PHASE 1GG, GODREJ ZEN ESTATE PHASE 1GH, GODREJ ZEN ESTATE PHASE 1GI, GODREJ ZEN ESTATE PHASE 1GJ, GODREJ ZEN ESTATE PHASE 1GK, GODREJ ZEN ESTATE PHASE 1GL, GODREJ ZEN ESTATE PHASE 1GM, GODREJ ZEN ESTATE PHASE 1GN, GODREJ ZEN ESTATE PHASE 1GO, GODREJ ZEN ESTATE PHASE 1GP, GODREJ ZEN ESTATE PHASE 1GQ, GODREJ ZEN ESTATE PHASE 1GR, GODREJ ZEN ESTATE PHASE 1GS, GODREJ ZEN ESTATE PHASE 1GT, GODREJ ZEN ESTATE PHASE 1GU, GODREJ ZEN ESTATE PHASE 1GV, GODREJ ZEN ESTATE PHASE 1GW, GODREJ ZEN ESTATE PHASE 1GX, GODREJ ZEN ESTATE PHASE 1GY, GODREJ ZEN ESTATE PHASE 1GZ, GODREJ ZEN ESTATE PHASE 1HA, GODREJ ZEN ESTATE PHASE 1HB, GODREJ ZEN ESTATE PHASE 1HC, GODREJ ZEN ESTATE PHASE 1HD, GODREJ ZEN ESTATE PHASE 1HE, GODREJ ZEN ESTATE PHASE 1HF, GODREJ ZEN ESTATE PHASE 1HG, GODREJ ZEN ESTATE PHASE 1HH, GODREJ ZEN ESTATE PHASE 1HI, GODREJ ZEN ESTATE PHASE 1HJ, GODREJ ZEN ESTATE PHASE 1HK, GODREJ ZEN ESTATE PHASE 1HL, GODREJ ZEN ESTATE PHASE 1HM, GODREJ ZEN ESTATE PHASE 1HN, GODREJ ZEN ESTATE PHASE 1HO, GODREJ ZEN ESTATE PHASE 1HP, GODREJ ZEN ESTATE PHASE 1HQ, GODREJ ZEN ESTATE PHASE 1HR, GODREJ ZEN ESTATE PHASE 1HS, GODREJ ZEN ESTATE PHASE 1HT, GODREJ ZEN ESTATE PHASE 1HU, GODREJ ZEN ESTATE PHASE 1HV, GODREJ ZEN ESTATE PHASE 1HW, GODREJ ZEN ESTATE PHASE 1HX, GODREJ ZEN ESTATE PHASE 1HY, GODREJ ZEN ESTATE PHASE 1HZ, GODREJ ZEN ESTATE PHASE 1IA, GODREJ ZEN ESTATE PHASE 1IB, GODREJ ZEN ESTATE PHASE 1IC, GODREJ ZEN ESTATE PHASE 1ID, GODREJ ZEN ESTATE PHASE 1IE, GODREJ ZEN ESTATE PHASE 1IF, GODREJ ZEN ESTATE PHASE 1IG, GODREJ ZEN ESTATE PHASE 1IH, GODREJ ZEN ESTATE PHASE 1II, GODREJ ZEN ESTATE PHASE 1IJ,

Artist's impression for representation purpose only



# Vadodara: A city that nurtures its heritage while inspiring modern marvels

With a rich architectural legacy and a deep commitment to preserving its traditions, Vadodara stands as a beacon of inspiration for many cities. At its heart, progress and preservation walk hand in hand, shaping a future that celebrates its roots, inspiring developments that honour its timeless beauty while paving the way for growth. Here, the city's rich culture breathes life into future developments, preserving Vadodara's heritage in every piece.

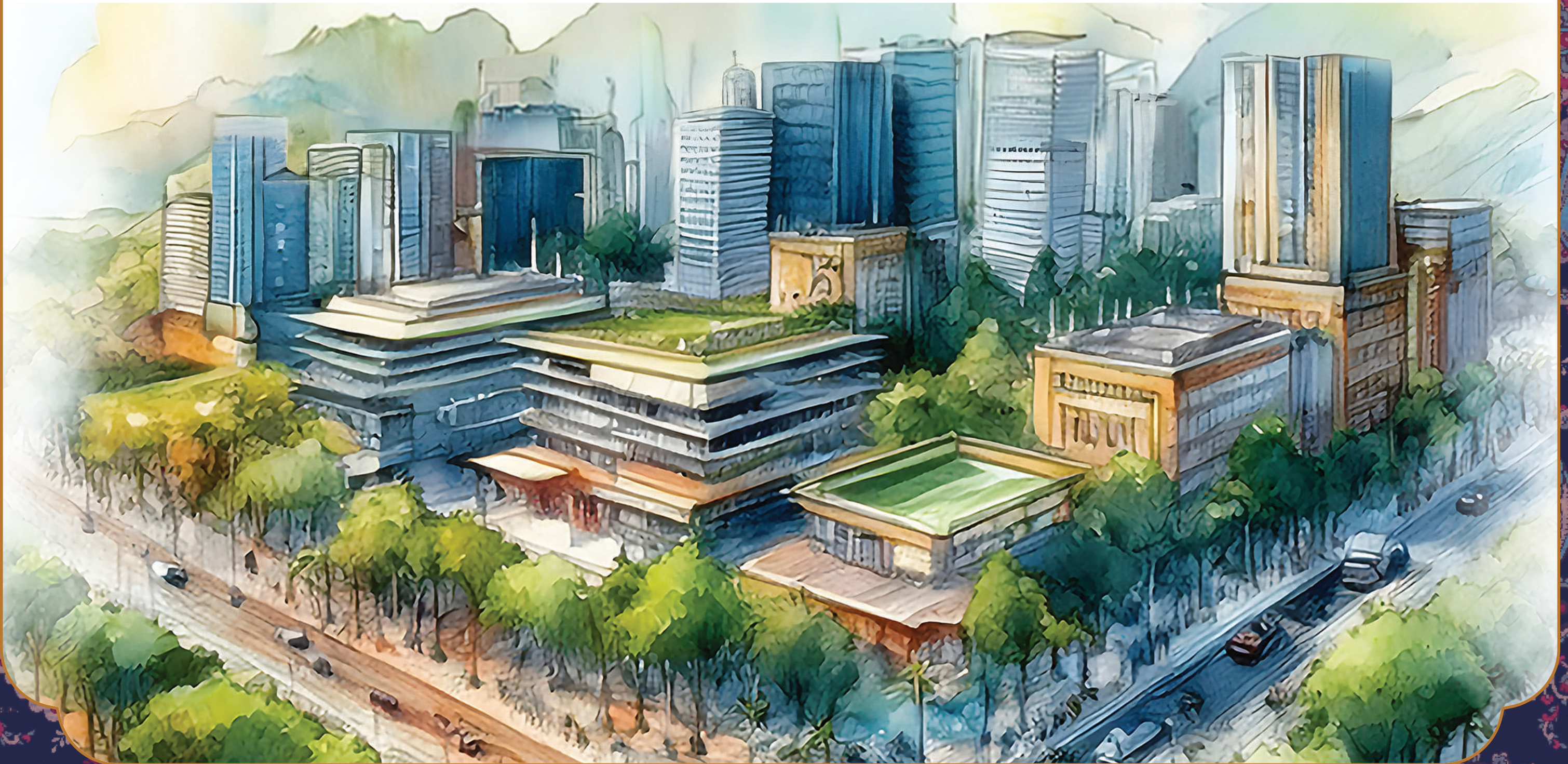



# Vadodara: A city poised for economic growth and progress

## THRIVING INDUSTRIAL BASE

Vadodara has a well-established industrial base with significant investments in prominent sectors, including chemicals, petrochemicals, pharmaceuticals, textiles, and engineering. It also hosts large facilities for major companies like Gujarat State Fertilisers & Chemicals (GSFC) and Gujarat Alkalies and Chemicals Limited (GACL).



## ROBUST INFRASTRUCTURE

Several key ongoing infrastructure projects, including the expansion of road and rail networks, along with the development of new business districts, are attracting investments and driving economic progress.



## STRATEGIC LOCATION ADVANTAGE

Situated near major ports like Kandla and Mumbai, Vadodara benefits from its proximity and thus has enhanced trade and logistics capabilities that fuel industrial and commercial growth in the city.



# Discover the future of progress in Vadodara-Ajwa, the new hub of growth



## CONNECTIVITY

It is well-connected to NH 8, the airport, as well as educational facilities like Sigma College and Podar International School.



## SOCIAL INFRASTRUCTURE

Essential facilities like hospitals, schools, colleges, markets, and banks are located on Ajwa Road along with serene water bodies and gardens.



## RETAIL & SHOPPING

It is conveniently located near malls, neighbourhood centres, and department stores for your ease and convenience.



## AMPLE GREEN SPACES

Find yourself surrounded by abundant greenery, with parks, temples, and talavs (water reservoirs).



## ENTERTAINMENT

Easy access to nearby water parks and amusement centres for recreational activities.



# The advantages of Vadodara-Ajwa's strategic location

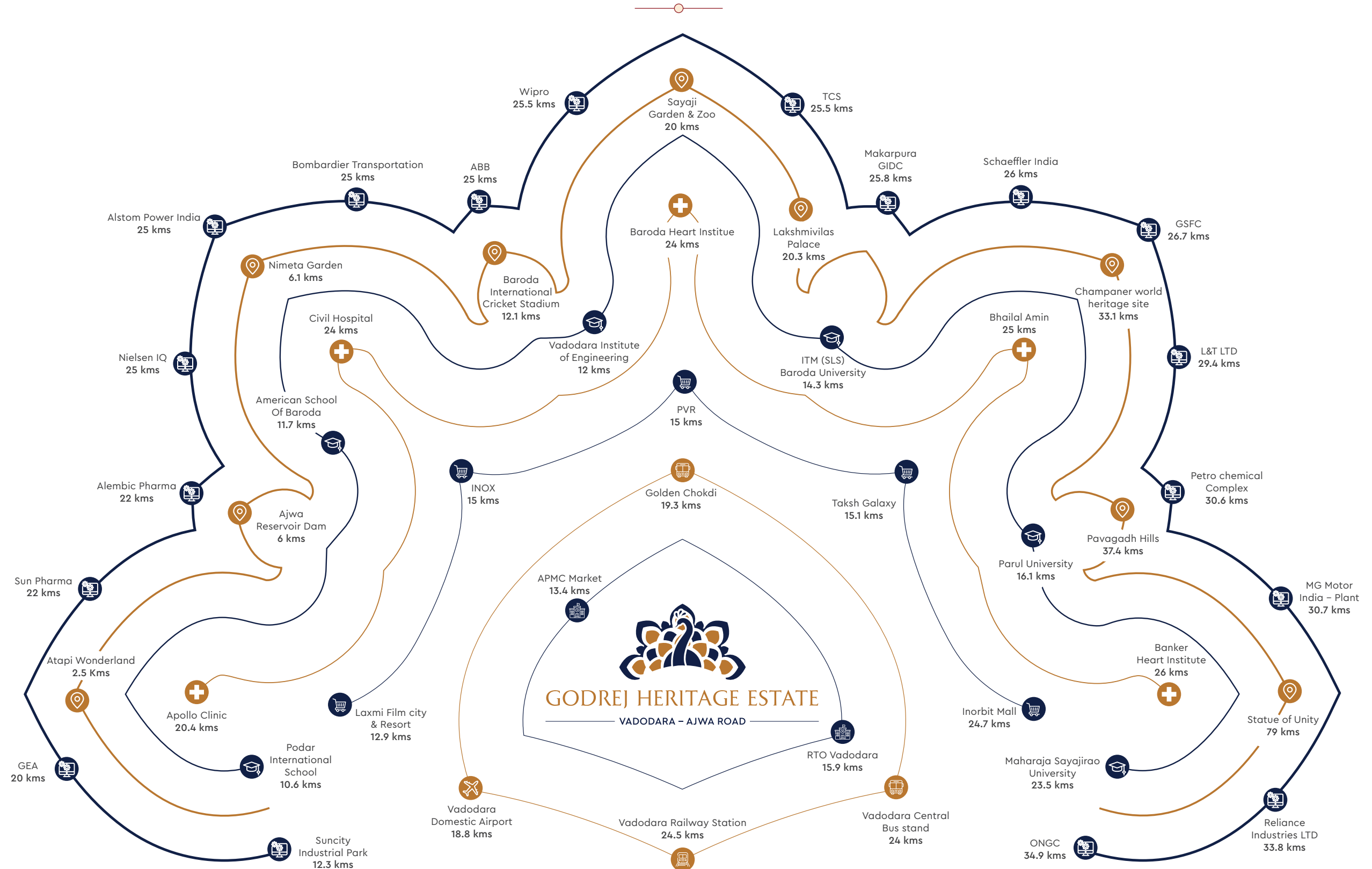

## LEGEND

- Government Offices
- Public Transport
- Malls & Entertainment
- Hospitals
- Schools & Universities
- Tourist Attractions
- Industrial & IT Hub



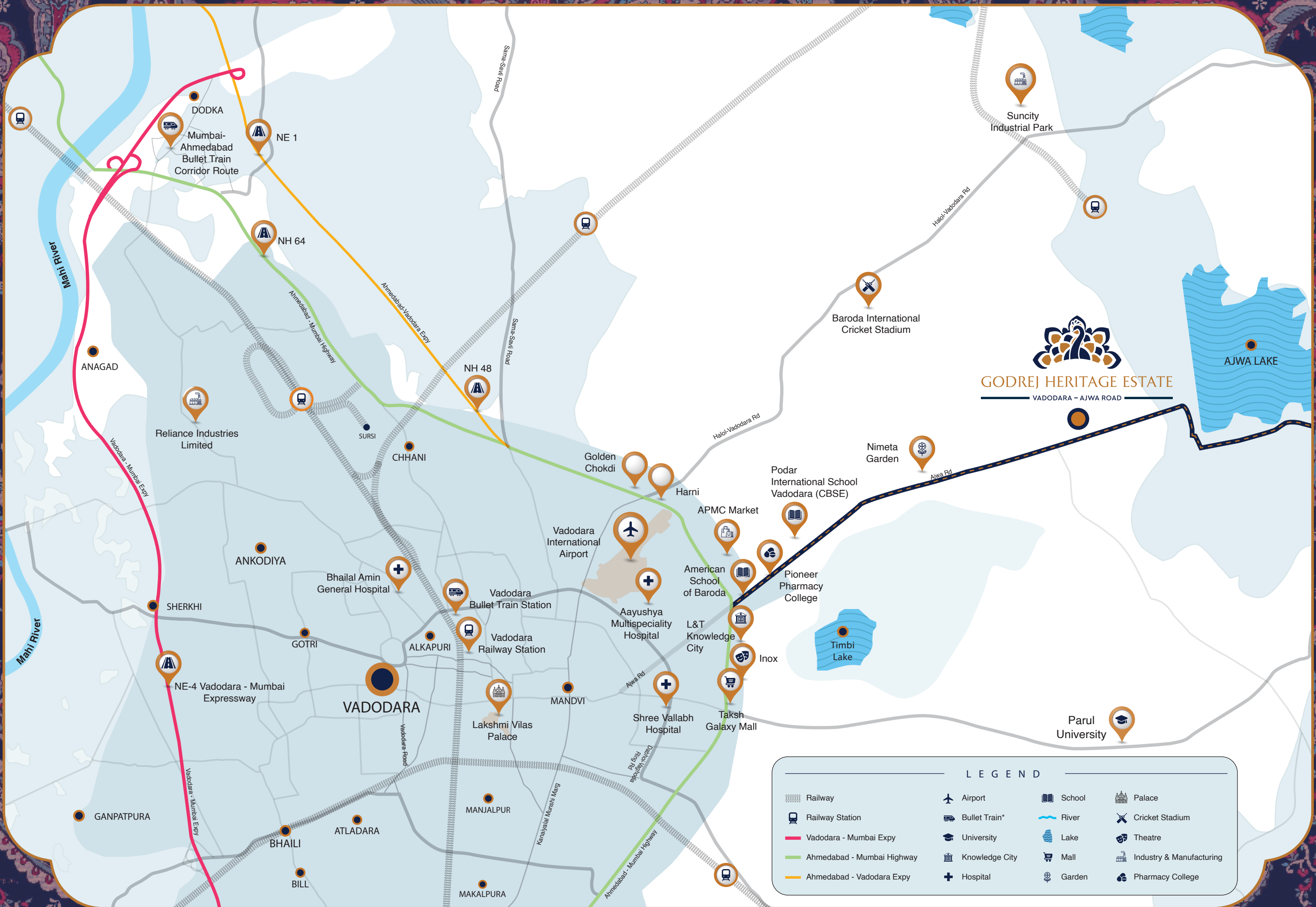

Map not to scale. The above map is for representation purpose only.  
<https://infra.economictimes.indiatimes.com/news/urban-transportation/gujarat-metro-rail-corporation-submits-dpr-for-vadodara-and-rajkot-metro-projects-to-union-govt/120718321>  
Source: Google maps\*

\*The proposed Bullet Train Station is under construction. Timelines and completion are subject to government authorities. The developer does not guarantee timelines or completion of such external developments.

\*The proposed metro rail is subject to approval, execution, and timelines of the concerned authorities. The developer has no control over the same and shall not be responsible for any changes, delays, or non-implementation.



# Gujarat's heritage, reimagined for modern living

Experience a world where time-honoured heritage meets the sophistication of modern design. With every corner reflecting cultural richness and every amenity catering to today's lifestyle, this is a place that promises an experience of a lifetime. Here, heritage is not only preserved but celebrated in every space, offering a living experience that's truly extraordinary.





# Unlock the immense potential of land and own your own piece of Gujarat today

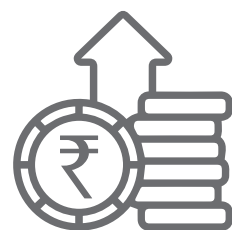

## Gain long-term value

Benefit from potential price appreciation and comparatively quicker resale value.



## Ideal for joint families

Enjoy the freedom of your own space, while staying connected to everything you need around you.



## Benefit of more space and freedom

Customise your home, enjoy privacy and comfort in a place that reflects your taste.



## Plant your private green oasis

Let your garden thrive, grow vegetables, plant fruit trees, and live sustainably in a quieter area outside the city.



## Build your dream home

Build a home that's truly yours, designed to your taste and crafted at your pace.\*



## Step into the freedom of open living

A place that's your own, with open spaces, easy parking, and the joy of shaping every corner to match your dreams.

Please note: All designs for building your home should adhere to the specifications and guidelines set by the developer.\*



Presenting

THE FIRST-EVER THEMED PLOTTED DEVELOPMENT  
IN VADODARA BY

*Godrej* | PROPERTIES



Launching



GODREJ HERITAGE ESTATE

— VADODARA – AJWA ROAD —

Your Piece of

Gujarat





EXPERIENCE A LIFE THAT PLACES HERITAGE  
AT THE HEART OF EVERYTHING



# A home rooted in heritage, built for future

Celebrating Gujarat's rich heritage, with modern comforts that make every day easier.





# Discover places to play and spaces to celebrate

A place for playful adventures and lively celebrations, crafted so every family can enjoy both fun and togetherness and create memories of a lifetime.

PARTY/GARBA LAWN



KIDS' PLAY AREA





# A garden that calms the mind and centres the soul

Walk slowly, breathe deeply and let the harmony of greens give you moments of balance, clarity and quiet joy, every day.





# Walk amidst serene gardens, embraced by heritage

Experience Gujarat's iconic green splendour brought to life in your backyard. With intricate trellises and welcoming promenades, the green landscaping here weaves visuals of timeless beauty before your eyes.







THOUGHTFULLY CURATED AMENITIES  
THAT HONOUR THE PAST  
WHILE ELEVATING THE PRESENT



Discover club-class amenities where leisure, wellness,  
and entertainment spread across ~ 25,000 sq.ft (2,322 sq.mt) come together



RECEPTION  
LOUNGE



MINI THEATRE  
AREA



GYMNASIUM



ATTENDANT'S  
ROOM



INDOOR KIDS'  
PLAY AREA



SPA AREA



GUEST ROOMS



INDOOR BADMINTON  
COURT

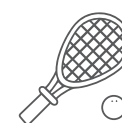

SQUASH COURT

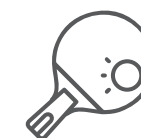

INDOOR GAMES  
ROOM



ZUMBA /  
YOGA ROOM



SWIMMING POOL



KIDS' POOL



SUNKEN SEATING



# Behold infrastructure that depicts timeless grandeur, designed for a life well-lived



WALKING TRACK



AMPHITHEATRE



ZEN GARDEN



GARBA/PARTY  
LAWN



WATERBODY



KIDS' PLAY  
AREA



GAZEBO



ORCHARD

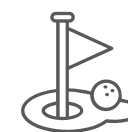

GOLF PUTTING  
AREA



PICKLE BALL  
COURT



CRICKET PITCH



SUNDIAL PLAY AREA



# A stage where the past inspires the present

An amphitheatre that celebrates the joy of gathering where stories are shared, performances come alive and every evening feels like a festival under the sky.





# COME HOME TO YOUR PIECE OF *Gujarat*

Come home to a life where the rich heritage of Gujarat surrounds you every day. Build your home in a space where every detail is inspired by the heritage of Gujarat, and every moment is an opportunity to create your own cherished memories as you own a piece of Gujarat for yourself.





## Plot Configuration

TYOLOGY	RANGE (SQ. FT.)	RANGE (SQ. MT.)
TYPE 1	1000 TO 1300	92.90 TO 120.77
TYPE 2	1301 TO 1500	120.87 TO 139.35
TYPE 3	1501 TO 2000	139.45 TO 185.80
TYPE 4	2001 TO 2500	185.90 TO 232.25
TYPE 5	2500+	232.25+



## Specification



ATTRACTIVE PLOT SIZE RANGES  
1100 - 2500+ SQ .FT  
(102.19-232.25 +SQ .MT)

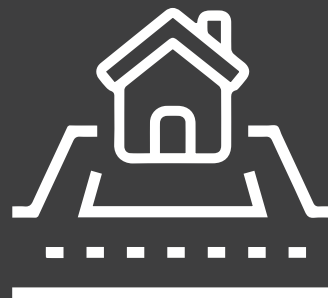

FREEDOM OF  
CONSTRUCTION



ELECTRICITY  
AND WATERLINE

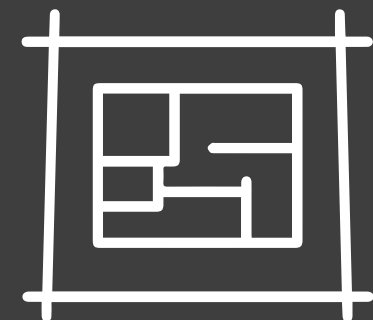

PERMISSIBLE FSI - 1.2



## RTGS Details

NAME OF THE BANK	BANK KEY/IFSC CODE	SWIFT CODE	ENTITY NAME	ACCOUNT TITLE	BANK ACCOUNT NUMBER
HDFC BANK	HDFC0003920	HDFCINBB	GODREJ PROJECTS DEVELOPMENT LIMITED	GPDL COLLECTION BANK ACCOUNT FOR GODREJ HERITAGE ESTATE	57500001693552





---

Site Office: Godrej Heritage Estate, Godrej Projects Development Ltd., Ajwa Nimeta Road, Vaghodia, Vadodara, Gujarat – 391510. The images shown are artist's impressions, stock images, or AI-generated. They are intended only as illustrations to indicate a possible layout and are not part of the standard specifications, amenities, or services of the project. The official website of Godrej Properties Limited is [www.godrejproperties.com](http://www.godrejproperties.com). Please do not rely on the information provided on any other website. This project is being developed by GODREJ PROJECTS DEVELOPMENT LIMITED (Developer). GODREJ® is a registered trademark. The same may not be used by any means or in any forms whatsoever without written permission. Any unauthorized use of the same shall constitute trademark infringement and will be subject to legal action in accordance with applicable laws. \*T&C Apply.